

SHILOHVISTA

Comfortable Home Sites in Urbana
 Spacious Lots
 Conveniently Located
 Great School System - Center Point Urbana

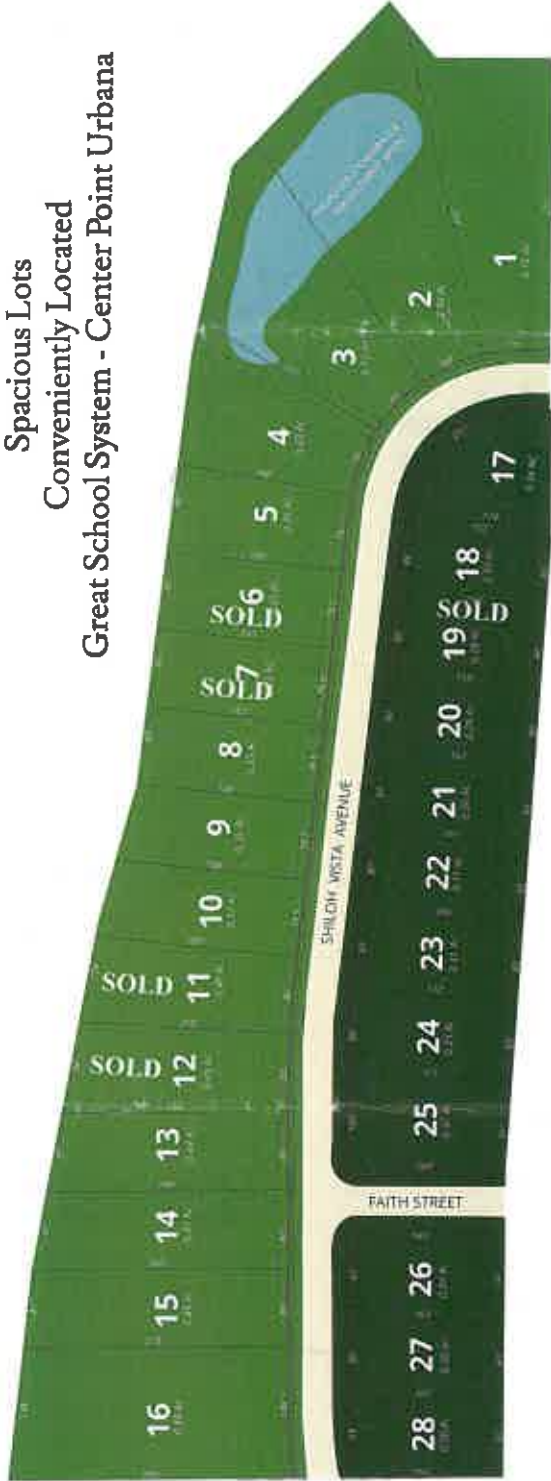

Restrictive Covenants
 Available Upon Request



Walkout Lot
 Standard Lot

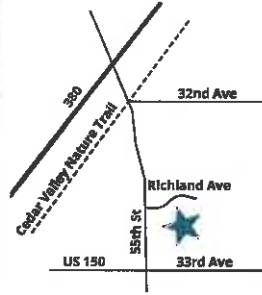

DIRECTIONS

From I-380, west on 55th Street to Richland Avenue. West on South Street. Then South on Endeavor Avenue. To Shiloh Vista Avenue.

Douglas D Laird
 CCIM, SIOR, FACHE
 319.360.8577
 dlaird@skogman.com



Part Owner is Licensed Realtor in the State of Iowa.



Society of Industrial &
 Office REALTORS®
 Individual Member

Urbana

**Shiloh
Vista Ave**

Lot Prices

<u>Lot number</u>	<u>SF</u>	<u>Acre</u>	<u>Walk out</u>	<u>Price</u>	<u>Comments</u>
1	33,106	0.76	yes	\$39,500	
2	43,124	0.99	yes	\$39,500	
3	31,363	0.72	yes	\$39,500	
4	20,909	0.48	yes	\$38,500	
5	15,246	0.35	yes	\$38,500	
6	14,375	0.33	yes		SOLD
7	14,375	0.33	yes		SOLD
8	14,375	0.33	yes	\$38,500	
9	15,246	0.35	yes	\$38,500	
10	16,117	0.37	yes	\$38,500	
11	17,424	0.4	yes		SOLD
12	19,602	0.45	yes		SOLD
13	19,166	0.44	yes	\$38,500	
14	20,473	0.47	yes	\$38,500	
15	21,344	0.49	yes	\$38,500	
16	38,333	0.88	yes	\$38,500	
17	14,697	0.34		\$35,500	Corner Lot
18	13,068	0.3		\$34,500	
19	12,632	0.29		\$34,500	SOLD
20	12,632	0.29		\$34,500	
21	13,068	0.3		\$34,500	
22	13,504	0.31		\$34,500	
23	13,504	0.31		\$34,500	
24	14,375	0.33		\$34,500	
25	16,117	0.37		\$35,500	Corner Lot
26	14,810	0.34		\$35,500	Corner Lot
27	13,068	0.3		\$34,500	
28	13,068	0.3		\$34,500	

Updated 1/2/18

